

Installation and Operational Guide

Please read the manual below for important information on your Viviox product that could prevent damage or serious injury. Failure to follow our instructions and other safety precautions could result in serious injury to you or your passengers, and/or product and vehicle damage.

Important: The installation technician and operator must read this manual before starting installation or operation of your new product. They must have a thorough understanding of automotive systems, electronics and procedures.

WARNING: Please understand that the user and installer assume ultimate, complete and full responsibility in determining proper mounting location and positioning. When installing, consider a location based on its ability to provide total safety to all passengers.

WARNING: DO NOT USE CIRCUIT BREAKERS WITH THIS PRODUCT! All customer-supplied wires that connect with the positive (+) end of the battery must be able to support 125% or more of the maximum operating current. They MUST be fused with the battery to handle the current.

- Before drilling and installation, check both sides of your mounting service.
- Grommets should be installed into all wire passage holes.
- Please read your vehicle's owner's manual; it contains important information about the airbag deployment area. This product should NOT, under any circumstances, be installed in the deployment area of the vehicle's airbag. Do NOT route any wires in this area. Having equipment mounted or located in this area is a serious risk; it could reduce or damage the airbag's effectiveness, or even become a projectile that could result in serious injury or death.
- This device may feature powerful, bright, high-intensity LED lights. DO NOT look at the lights directly, as momentary blindness and/or permanent eye damage can occur.
- DO NOT try to activate or control this product during a hazardous or dangerous driving situation.
- If your device is controlled or activated by a remote, please double check that the control is in a place that will allow for both the control itself, as well as the vehicle, to be used safely in any driving condition and/or situation.

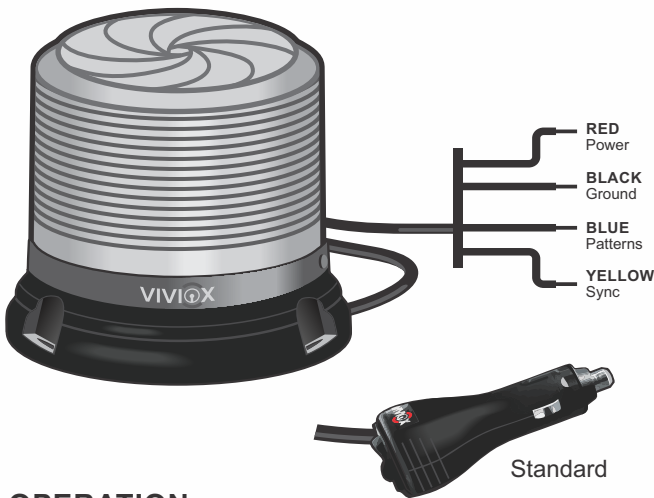

OPERATION

The Adonis 1000 Beacon can be operated with the included cigarette lighter plug or hardwired to your vehicle.

For standard cigarette plug operation:

1. Insert the Adonis plug into your cigarette lighter plug.
2. Use the backlight switch to turn it on or off.
3. To change patterns, activate the second switch for one second.

To Hardwire to Your Vehicle, please refer to the diagram above

2. Changing Patterns:

Patterns can be changed by momentarily connecting the blue wire to the ground of your vehicle's battery.

Less than a second	Next Pattern
1-3 Seconds	Previous Pattern
3-5 Seconds	Factory Default
5+ Seconds	Turn off and Reset

Syncing Instructions: Configure both Adonis Beacons to the same pattern in Phase 1 and connect the yellow wires from each light head together.

To Have Your Adonis Beacons Alternate, set every other light to the same pattern in Phase 2 and connect yellow wires. To better understand how this feature works, each beacon head coming from the factory will display Phase 1. In order to have an Adonis Beacon alternate with another, every other light needs to be advanced to the current pattern's Phase 2.

FLASH PATTERNS

1. Single Flash 75 FPM Phase 1 (SIM) – Sync
2. Single Flash 75 FPM Phase 2 (SIM) – Sync
3. Single Flash Rotator 75 FPM
4. Single Flash Rotator 100 FPM
5. Single Flash 120 FPM Phase 1 (SIM) – Sync
6. Single Flash 120 FPM Phase 2 (SIM) – Sync
7. Single Flash Rotator 120 FPM
8. Single Flash Rotator 150 FPM
9. Single Flash 375 FPM Phase 1 (SIM) – Sync
10. Single Flash 375 FPM Phase 2 (SIM) – Sync
11. Single Flash Rotator 375 FPM
12. Double Flash 75 FPM Phase 1 (SIM) – Sync
13. Double Flash 75 FPM Phase 2 (SIM) – Sync
14. Double Flash 130 FPM Phase 1 (SIM) – Sync
15. Double Flash 130 FPM Phase 2 (SIM) – Sync
16. Double Flash Rotator 130 FPM
17. Triple Flash 130 FPM Phase 1 (SIM) – Sync
18. Triple Flash 130 FPM Phase 2 (SIM) – Sync
19. Quad Flash 75 FPM Phase 1 (SIM) – Sync
20. Quad Flash 75 FPM Phase 2 (SIM) – Sync
21. Quad Flash Rotator 75 FPM
22. ECE R65 Rotator Flash 120
23. ECE R65 Rotator Flash 60
24. CA T13 Single Flash 75FPM (SIM)
25. CA T13 Double Flash 75FPM (SIM)
26. NFPA-Quad Flash 75FPM (SIM)
27. ModuFlash (SIM)
28. AUTORUN (Random)
29. Steady Burn
30. OFF

MOUNTING

Surface Mounting (See Figure 1.)

The Adonis Beacon comes standard with a powerful magnetic mount.

For Permanent Mounting, (See Figure 2.)

1. Select the mounting location for your Adonis Beacon and mark the three mounting holes.
 2. Use a drill to make three holes and a central wire passage hole.
 3. Secure the beacon with three screws (customer supplied).
- Choose the right screws depending on your mounting location

SPECIFICATIONS

Dimensions: 4" H, 4.25"

Input Voltage: 10-30VDC **Input Current:** 1.8A (MAX)

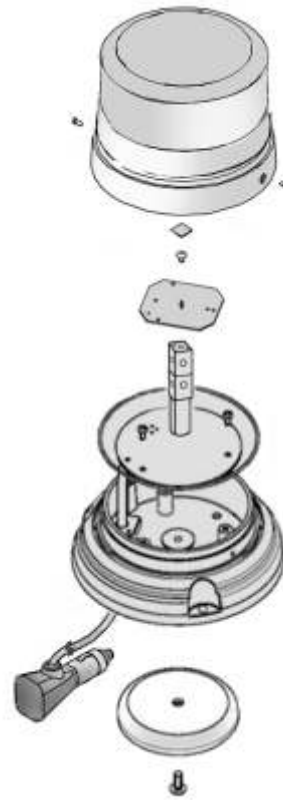

Figure 1.

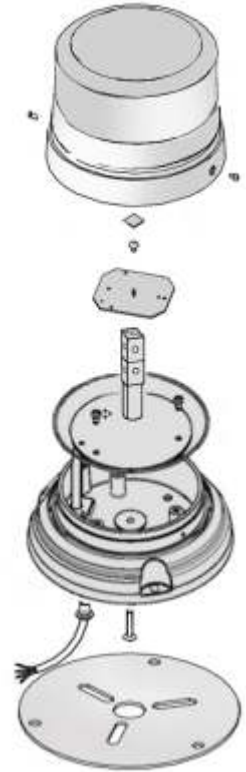

Figure 2.